

Wee Hur to officially launch 517-unit industrial development MEGA@Woodlands on 15 January 2016, already sold 57 units before official launch

- MEGA@Woodlands, an eight-storey ramp-up/flatted industrial development for B1 clean and light, and B2 general industry, is one of the largest among recently launched industrial projects
- Property comprises 517 factory units, with unit size from 1711 sq ft
- Property offers mega specifications and amenities which include a Sky Lounge comprising a first-of-its-kind dedicated business center featuring meeting rooms of various capacities and gym with shower facilities, three sky gardens with jogging trail and outdoor fitness stations

Singapore, 13 January 2016 – Wee Hur Holdings Ltd, (“Wee Hur” or “the Group”) (偉合控股有限公司), an SGX mainboard-listed property developer and BCA Grade A1 award winning builder, is officially launching its latest and largest industrial project till date, MEGA@Woodlands, on 15 January 2016.

This industrial complex is a modern eight-storey ramp-up/flatted industrial building for B1 clean and light , and B2 general industry comprising 517 units, each from 1711 sq ft.



Artist's Impression of MEGA@Woodlands

This mega complex will offer mega specifications and amenities such as 20/40 ft container access, container parking lots, wide driveway, 5.95 m floor to floor height, 830 carpark lots, 300 lorry lots, semi-D concept units, sky lounge, a first-of-its-kind business center, BBQ pits, minimart, clinic, canteens, and common amenities such as gym, fitness stations, and sky gardens.

The property offers ample parking for all its units, with 120 lots for heavy vehicle, 300 lorry lots and 830 carpark lots. To cater to longer, articulated container trucks, it will also come with 2 lots for 40-foot and 6 lots for 20-foot articulated vehicle parking and has high ceiling of 5.95 m floor to floor height.

The property's Sky Lounge comprises a first-of-its-kind dedicated business center with three meeting rooms, one boardroom, one discussion room, a reception lobby as well as a gym with shower facilities. Another unique feature is the property's three sky gardens, one on the rooftop featuring a unique water feature, jogging trail, outdoor fitness stations and BBQ pits, and two located at the second level with pavilions surrounded in greenery. This mega complex will not just be more conducive for business, but also more favourable as a work location.

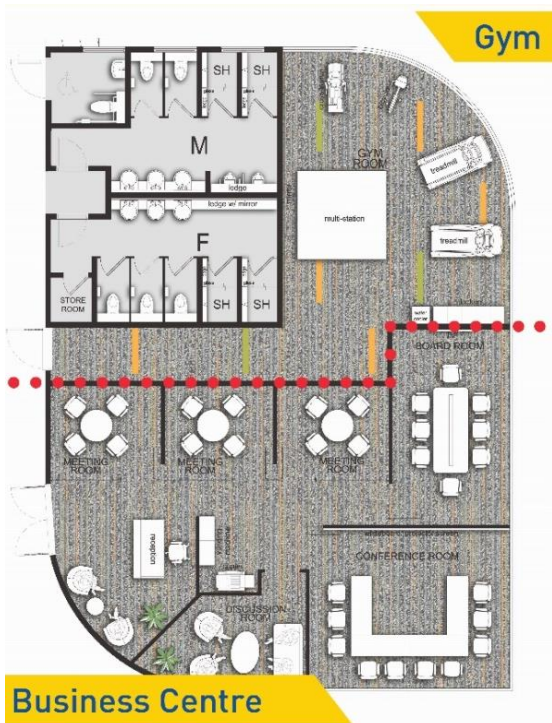

Layout of Sky Lounge



Artist's Impression of Sky Lounge

Located along Woodlands Ave 12 at approximately 10 minutes' walk from Admiralty MRT Station, this new industrial complex is near to the future Woodlands South MRT station of the proposed Thomson-East Coast line, the Woodlands Regional Centre and the Causeway. The site's location offers excellent transport connectivity via Seletar Expressway and the future North-south Expressway.

MEGA@Woodlands is the Group's third industrial development project following its successful completion of Harvest@Woodlands and Premier@Kaki Bukit.

The show unit is open now. Visit MEGA@Woodlands at 39 Woodlands Close, Singapore 737856, or dial +65 8118 8882. To celebrate the official launch of MEGA@Woodlands, light refreshments will be served from 10 am to 8 pm on 15 January 2016.

For more details on MEGA@Woodlands, please visit www.megawoodlands.com.sg.

- The End -

About Wee Hur Holdings Ltd

Wee Hur Holdings Ltd. (“Wee Hur”) was listed on the Singapore Exchange Main Board in 2008. Since then, we have expanded our core business from construction to include property development and dormitory operation.

The property development business is undertaken by wholly-owned Wee Hur Development Pte. Ltd. (“WHD”) and Wee Hur International Pte Ltd (“WHI”) for local market and overseas market respectively. WHD is currently developing residential project, Parc Centros, and industrial project, MEGA@Woodlands. Some of its past projects include residential project, Urban Residences, and industrial projects, Harvest@Woodlands and Premier@Kaki Bukit. WHI is currently developing a mixed-use project comprising residential, retail, office and student accommodation on three adjacent plots in Brisbane, Australia. WHI has also acquired an existing office building at 80 Ann Street and 71-79 Turbot Street in Brisbane CBD for possible redevelopment into residential and commercial property.

The construction business is undertaken by wholly-owned Wee Hur Construction (“WHC”) which was established since 1980. WHC is a BCA registered contractor at Grade A1 which allows it to tender for public projects without any limit in contract value. WHC undertakes various types of projects from both private and public sectors, such as residential, commercial, industrial, institutional, religious, restoration and conservation projects. It is currently building Parc Centros and MEGA@Woodlands and also HDB precincts, Fernvale Riverwalk and Matilda Court. Some of its recent past projects include residential project, Urban Residences, industrial project, Premier@Kaki Bukit, and HDB precincts, Fernvale Riverbow and Vista Spring.

Wee Hur holds 60% stake in Active Engineering System Pte. Ltd. which operates Tuas View Dormitory, a 16,800-bed purpose-built workers’ dormitory, presently largest in Singapore. This purpose-built dormitory is equipped with gym, street soccer court, multipurpose hall, outdoor basketball courts, beer garden, TV room and commercial amenities like cinema, minimart, mobile phone shop, remittance shops, ATMs, barber, general clinic and dental clinic.

Issued for and on behalf of Wee Hur Holdings Ltd

For more information please contact:

Financial PR Pte Ltd

El LEE, Associate Director, el@financialpr.com.sg

Tel: (65) 6438 2990

Fax: (65) 6438 0064

staff@financialpr.com.sg